

# Floor Plan

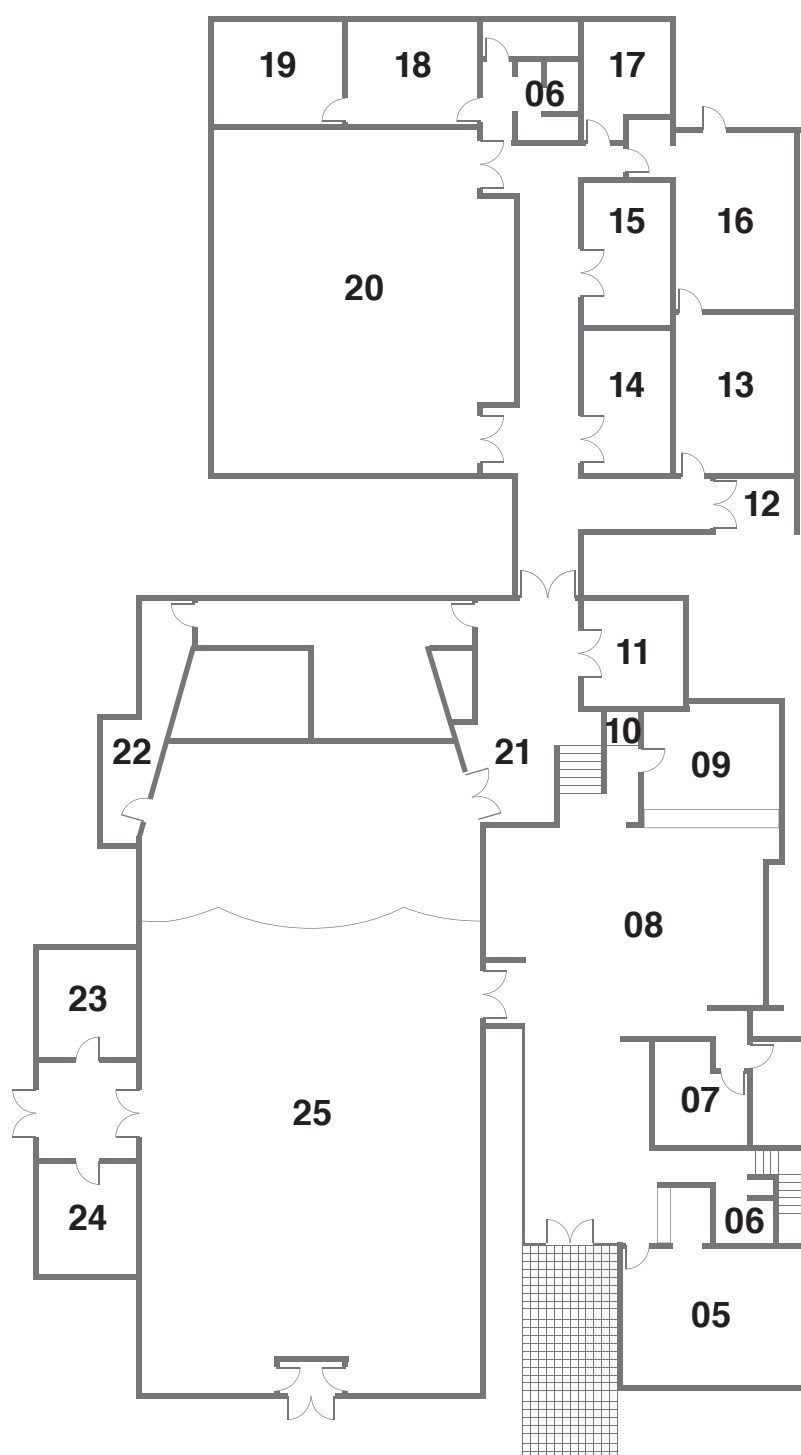

- 01** Louise's Studio
- 02** Bowater Studio
- 03** Lilburn Studio
- 04** Heberd Studio
- 05** Reception
- 06** Accessibility Toilets
- 07** Toilets
- 08** Foyer
- 09** Kitchen
- 10** Mobility Lift
- 11** Sturgeon Steinway Studio
- 12** Stage Door
- 13** Classroom
- 14** Taylor Green Room
- 15** McKee Green Room
- 16** Meeting Room
- 17** Civic Trust Library
- 18** Pochin Studio
- 19** Secker Studio
- 20** Recital Theatre
- 21** Stage Left
- 22** Stage Right
- 23** NBS Studio
- 24** Sturgeon Studio
- 25** Auditorium

